

Model cote:

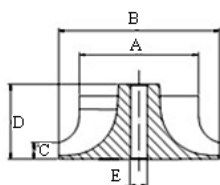

Copresoare :

Turbo KKK

Model	OEM	Descriere	A Diametrul mic	B Inaltimea paletei	C Diametrul mare	Nr.Palet
K03	5303-123-2011	Curbate inapoi Merge la:s 5303-970-0003 5303-970-0006 5303-970-0007 5303-970-0008 5303-970-0015 5303-970-0016 5303-970-0017 5303-970-0020 5303-970-0036 5303-970-0069 5303-970-0070 5303-970-0077	31.55	5.87-1.8	45	4 mari 4 mici
K03	Sant: 4.00mm	Curbate inapoi	31.55	5.87-1.57	45	4 mari 4 mici
K03	5303-123-2007	Curbate inapoi Merge la:s 5303-970-0010 5303-970-0028	33.8	6.4-1.8	45	4 mari 4 mici
K03	5303-123-2021	Curbate inapoi Merge la:s 5303-970-0009 5303-970-0018 5303-970-0023 5303-970-0024 5303-970-0050 5303-970-0051 5303-970-0056 5303-970-0057 5303-970-0061 5303-970-0062 5303-970-0063	34.5	5.87-1.8	46	4 mari 4 mici
K03	5303-123-2013 5303-123-2016 5303-123-2018	Curbate inapoi Merge la:s 5303-970-0009 5303-970-0014 5303-970-0019 5303-970-0038 5303-970-0047 5303-970-0060	33.6	6.5-1.8	46	6 mari 6 mici
K03		Curbate inapoi	33.6	5.7-1.8	46	6 mari 6 mici
K03	OEM is Billet	Curbate inapoi	34	5.7-1.8	47.8	6 mari 6 mici
K03	5304-123-2007 5304-123-2018	Curbate inapoi	35.9	6.5-1.8	50	6 mari 6 mici
K04	5304-123-2005 Sant : 4.41mm	Curbate inapoi	34.55	6.6-1.8	50	6 mari 6 mici
K04	5304-123-2000 Sant : 4.61mm	Curbate inapoi Merge la:s 5304-970-0001 5304-970-0004 5304-970-0005 5304-970-0006 5304-970-0008 5304-970-0017	34.55	6.6-1.8	50	6 mari 6 mici

K04	5304-123-2032	Curbate inapoi Merge la:s 5303-970-0048 5303-970-0104 5303-970-0120 5303-970-0121	34.6	6.0-1.8	51	6 mari 6 mici
K04		Curbate inapoi	34.2	5.5-1.8	51	6 mari 6 mici
K04	5304-123-2023 5304-123-2223	Curbate inapoi Merge la: 5303-970-0146	36.7	6.0-1.8	51	6 mari 6 mici
K04	5304-123-2029	Curbate inapoi Merge la:s 5303-970-0052 5303-970-0053 5303-970-0058 5303-970-0073 5303-970-0082 5304-970-0024 5303-970-0027 5303-970-0048	38.1	7.25-1.8	51	4 mari 4 mici
K04	5304-123-2201 5304-123-2204	Curbate inapoi Merge la:s 5303-970-0034 5303-970-0054 5303-970-0071 5303-970-0072 5303-970-0075 5303-970-0076	38.45	7.35-1.8	51	6 mari 6 mici
K04	5304-123-2024	Curbate inapoi Merge la:s 5303-970-0046 5303-970-0081 5303-970-0083 5303-970-0084 5303-970-0096	38.5	6.70-1.8	51	6 mari 6 mici
K04	5304-123-2202 5304-123-2208 5304-123-2222 5304-123-2228	Mix-flow style	37.9	5.8-1.8	51~54	6 mari 6 mici
K04	5304-123-2205	Mix-flow style	39.4	6.05-1.8	51~54	6 mari 6 mici
K04	5304-123-2036	Mix-flow style Merge la: 5303-970-0086 5303-970-0087 5303-970-0105 5303-970-0106	41.03	6.05-1.8	51~54	6 mari 6 mici
K06	5306-123-2007	Mix-flow style Merge la:s 5304-970-0049 5304-970-0059 Length:25.7mm	43.3	6.23-1.8	56~59	6 mari 6 mici
K04		Mix-flow style Length:25.7mm	45	6.23-1.8	56~59	6 mari 6 mici
K04	Merge la: 5304-970-0050	Mix-flow style Length: 27.7mm	43.3	6.23-1.8	56~59	6 mari 6 mici
K06	5306-123-2006	Mix-flow style Merge la: 5304-970-0033	45.05	6.36-1.8	56~59	6 mari 6 mici
K14	5314-123-2002 5314-123-2043	Drepte inapoi	35.15	4.68	50	6 mari 6 mici
K16	5316-123-2002 5316-123-2004	Drepte inapoi	35.2	4.51	55	6 mari 6 mici
K16	5316-123-2001 5316-123-2003	Drepte inapoi	36.5	4.51	55	6 mari 6 mici
K16		Drepte inapoi	44.4	6.15	60.6	6 mari 6 mici
K16	Billet CW	Curbate inapoi	44.2	8.1-4.0	63.5	6 mari 6 mici
K16	5324-123-2039	Curbate inapoi	44.2	8.1-4.0	63.5	6 mari 6 mici
K24		Curbate inapoi	46.9	9.1-4.0	59.8	7 mari 7 mici
K24	5324-123-2017	Drepte inapoi	38.8	4.55	60.6	6 mari 6 mici
K24	5324-123-2000 5324-123-2014 5324-123-2017	Drepte inapoi	36.2	5.2	60.6	6 mari 6 mici
K24	5326-123-2210	Curbate inapoi	47.45	8.45-4.0	68.5	7 mari 7 mici
K24	5324-123-2206	Mix-flow style	49.6	7.55-2.7	62~65.6	6 mari 6 mici
K27		Curbate inapoi	54.68	12.3-5.0	71.0	7 mari 7 mici

K27	5327-123-2309 5327-123-2226	Curbate inapoi	47.35	9.5-3.5	73.9	7 mari 7 mici
K27	Billet CW	Curbate inapoi	54.65	10.2-5.0	77.0	7 mari 7 mici
K27	5070-123-2065	Curbate inapoi	54.65	10.2-5.0	77.0	7 mari 7 mici
K27	5327-123-2035 5327-123-2227	Curbate inapoi	50.15	9.55-3.5	81.0	7 mari 7 mici
K27		Drepte inapoi	56.8	7.6	81.8	7 mari 7 mici
K27		Curbate inapoi	58.75	11.4-5.0	82.6	7 mari 7 mici
K27	5327-123-2225	Curbate inapoi	57.35	9.9-3.5	83.0	7 mari 7 mici
K27		Curbate inapoi	57	9.05-1.1	85.0	7 mari 7 mici
K28	Radial wheel	Drepte inapoi	57.7	8.12	82.0	6 mari 6 mici
K29	5329-123-2228	Curbate inapoi	63.1	12.96-6.0	90.5	6 mari 6 mici
K31	5333-123-2019	Curbate inapoi Merge la: 5333-970-6490	66.75	12.8-6.0	102	7 mari 7 mici
K33	5336-123-2025	Curbate inapoi	71.4	11.95-4.0	102	7 mari 7 mici
K33	5336-123-2020 Sant: 7.938mm	Curbate inapoi	61.15	11.00-4.0	102	7 long 7short
K36	5336-123-2028	Drepte inapoi	68	8.4	102	7 mari 7 mici
K36	312120 Radial wheel	Drepte inapoi	67.97	8.9	94	6 mari 6 mici
K37	5337-123-2027	Curbate inapoi	76.7	16.02-8.0	118	7 mari 7 mici
K37	5337-123-2026	Curbate inapoi	83.6	17.14-8.0	118	7 mari 7 mici
KP31	5431-123-0001	Drepte inapoi	22.2	3.2	33	5 mari 5 mici
KP31		Drepte inapoi	23.1	3.43	33	5 mari 5 mici
KP35		Drepte inapoi	25.41	3.53	37	5 mari 5 mici
KP35	5435-123-2005	Curbate inapoi Merge la:s 5435-970-0005 5439-970-0006	25.9	6.8-2.8	37	5 mari 5 mici
KP35	5435-123-2009	Curbate inapoi Merge la: 5435-970-0014	27	6.0-2.8	37	5 mari 5 mici
KP35		Drepte inapoi	27.35	4.3	37	5 mari 5 mici
KP35	5435-123-2002 5435-123-2007	Curbate inapoi Merge la:s 5435-970-0001 5435-970-0007 5435-970-0009	27.35	6.8-3.63	37	5 mari 5 mici
KP35		Curbate inapoi	25.93	6.3-2.8	39	5 mari 5 mici
KP35	5443-123-2010	Curbate inapoi	27.45	6.5-2.8	41	5 mari 5 mici
KP35	5439-123-2001	Drepte inapoi Merge la:s 5435-970-0000 5435-970-0002 5435-970-0003	29.5	4.2	41	5 mari 5 mici
KP/BV39	5443-123-2020	Curbate inapoi Merge la: 5439-970-0027	30.9	6.2-2.8	46	6 mari 6 mici
KP/BV39	5443-123-0031	Curbate inapoi	33.6	6.75-2.8	46	6 mari 6 mici
KP/BV39	5443-123-2008 5443-123-2012	Drepte inapoi Merge la:s 5439-970-0006 5439-970-0007 5439-970-0008 5439-970-0010 5439-970-0011 5439-970-0022	33.55	4.0	46	6 mari 6 mici

KP/BV39	5443-123-2007	Drepte inapoi Merge la:s 5439-970-0005 5439-970-0012 5439-970-0016 5439-970-0023 5439-970-0047 5439-970-0083	34.6	4.15	46	6 mari 6 mici
KP/BV39	5443-123-2017 5443-123-2037	Mix-flow style Merge la:s 5439-970-0030 5439 970 0070	31	5.8-2.8	46~48.8	5 mari 5 mici
KP/BV39		Curbate inapoi Mix-flow style	32.3	6.2-2.8	46~48.8	5 mari 5 mici

Turbo Garrett						
Model	OEM	Descriere	A Diametrul mic	B Inaltimea paletei	C Diametrul mare	Nr.Palet
T2	410450-0012	Curbate inapoi	32.3	6.8-2.4	48	6 mari 6 mici
T2	410450-0011	Curbate inapoi	33.85	7.3-2.4	48	6 mari 6 mici
T2		Curbate inapoi	34	7.2-2.4	48	6 mari 6 mici
T2	410450-0014	Curbate inapoi	37.2	8.0-2.4	48	6 mari 6 mici
T2		Curbate inapoi	36.3	7.15-2.4	49	6 mari 6 mici
T25	431350-0017 431350-0019	Curbate inapoi	36.35	7.94-2.4	51.4	6 mari 6 mici
T25	431350-0001 431350-0007 431350-0015	Curbate inapoi	39.9	9.0-2.4	51.4	6 long 6 shrot
T25	431350-0016	Curbate inapoi	38.15	8.43-2.4	51.4	6 mari 6 mici
T25		Curbate inapoi	39.8	8.6-2.4	51.4	6 mari 6 mici
T25	432348-0003	Curbate inapoi	43	8-2.25	51.4	6 mari 6 mici
T25	447449-0011	Curbate inapoi	38.66	8.18-2.4	52.2	6 mari 6 mici
T25	447449-0008	Curbate inapoi	38.75	7.07-2.4	52.2	6 mari 6 mici
T25		Curbate inapoi	37.6	7.07-2.4	52.2	6 mari 6 mici
T25		Curbate inapoi	37.5	8.0-2.4	54	5 mari 5 mici
T25		Curbate inapoi	38.2	6.7-2.4	54	5 mari 5 mici
T25	446335-0009	Curbate inapoi	38.2	8.0-2.4	54	5 mari 5 mici
T25	446335-0010	Curbate inapoi	41.95	8.0-2.4	54	5 mari 5 mici
T25	445347-0003	Curbate inapoi	42.15	7.74-2.4	54.5	6 mari 6 mici
T25	707747-0005	Curbate inapoi	39.6	6.35-2.4	56.1	6 mari 6 mici
T28	445436-0007	Curbate inapoi	47.19	7.65-2.4	60.1	6 mari 6 mici
T28	445436-0009	Curbate inapoi	47.19	8.5-2.4	60.1	6 mari 6 mici
T28	445436-0001	Curbate inapoi	46.45	8.5-2.4	60.1	6 mari 6 mici
T28		Curbate inapoi	47.7	8.0-2.4	60.1	6 mari 6 mici
T28	445436-0011	Curbate inapoi	42.5	7.36-2.4	60.1	6 mari 6 mici
T28		Curbate inapoi	42.85	7.55-2.4	60.1	6 mari 6 mici
T28		Curbate inapoi	44.65	8.45-2.4	60.1	6 mari 6 mici

T28	452546-0003		51.25	8.3-2.4	71	6 mari 6 mici
T3		Curbate inapoi	42.05	8.64-2.0	59	6 mari 6 mici
T3	409096-0010	Curbate inapoi	35.45	7.7-3.72	60.1	6 mari 6 mici
T3	409096-0006 409096-0013	Curbate inapoi	46.5	9.75-3.72	60.1	6 mari 6 mici
T3	409096-0004 409096-0011	Curbate inapoi	37.7	8.3-3.72	60.1	6 mari 6 mici
T3	409096-0001 409096-0008	Curbate inapoi	40.56	8.9-3.72	60.1	6 mari 6 mici
T3	409096-0005 409096-0014	Curbate inapoi	42.5	8.75-3.72	60.1	6 mari 6 mici
T3	409096-0009	Curbate inapoi	44.65	9.75-3.72	60.1	6 mari 6 mici
T3		Curbate inapoi	48.3	9.70-3.72	60.1	6 mari 6 mici
T3	446340-0001	Curbate inapoi	43.75	9.7-3.72	63	6 mari 6 mici
T3		Curbate inapoi	48.6	9.0-2.0	66.7	6 mari 6 mici
T3	441341-0002	Curbate inapoi Merge la: 452059 / 465553	48.9	9.4-3.72	68.9	7 mari 7 mici
T3	Palete inverse	Curbate inapoi	48.9	9.4-3.72	68.9	7 mari 7 mici
T04B		Curbate inapoi	45.7	8.6-1.6	67	8 mari 8 mici
T04B		Curbate inapoi	47.6	8.25-1.6	68	8 mari 8 mici
T04B	Fit Vtrim	Curbate inapoi	54.2	8.7-1.6	69	8 mari 8 mici
T04B	409179-0028	Curbate inapoi	43.7	7.0-1.6	70	8 mari 8 mici
T04B	409179-0029	Curbate inapoi	45.7	8.3-1.6	70	8 mari 8 mici
T04B		Curbate inapoi	45.7	8.3-1.6	70	6 mari 6 mici
T04B	409179-0018	Curbate inapoi	48.4	8.6-1.6	70	8 mari 8 mici
T04B	409179-0023	Curbate inapoi	51.6	8.0-1.6	70	8 mari 8 mici
T04B	409179-0024	Curbate inapoi	54.15	8.54-1.6	70	8 mari 8 mici
T04B	409179-0025	Curbate inapoi	55.4	8.84-1.6	70	8 mari 8 mici
T3		Curbate inapoi	51.2	9.5-3.65	71	6 mari 6 mici
TB34	442293-0006	Curbate inapoi	47.5	10.3-5.0	75	6 mari 6 mici
TBP4	442293-0012	Curbate inapoi	49.7	10.9-5.0	75	6 mari 6 mici
T04E	442476-0011	Curbate inapoi	55.0	11.49-5.0	75	6 mari 6 mici
T04E	442476-0017	Curbate inapoi	58.0	12.1-5.0	75	6 mari 6 mici
TB34		Curbate inapoi	56.6	11.78-5.0	75	6 mari 6 mici
T04E	442476-0014	Curbate inapoi	56.6	11.45-5.0	75	6 mari 6 mici
TBP4	442293-0015	Curbate inapoi	50.9	12.1-5.0	75	6 mari 6 mici
TB41	409535-0001	Curbate inapoi Merge la: 465981-0002	59.0	13.2-5.0	76	7 mari 7 mici
T04E		Curbate inapoi	50.8	10.77-5.0	76.2	6 mari 6 mici
TBP4		Curbate inapoi	50.4	9.8-5.0	76.2	6 mari 6 mici
TBP4	448048-0007	Curbate inapoi	51.1	10.4-5.0	76.2	6 mari 6 mici
TBP4	451320-0005	Curbate inapoi	51.7	11.1-5.0	76.2	6 mari 6 mici
TBP4	448112-0002	Curbate inapoi	52.9	11.1-5.0	76.2	6 mari 6 mici
TBP4	448048-0004	Curbate inapoi	53.9	10.8-5.0	76.2	6 mari 6 mici
TBP4		Curbate inapoi	54.9	11.1-5.0	76.2	6 mari 6 mici

TBP4	727591-0004 : 1/4-28-LH	Curbate inapoi	54.9	11.1-5.0	76.2	6 mari 6 mici
T4		Curbate inapoi	58.5	10.6-5.0	76.2	7 mari 7 mici
T4		Curbate inapoi	54	10.6-5.0	81.2	6 mari 6 mici
T4		Curbate inapoi	58.1	10.8-5.0	81.2	6 mari 6 mici
TBP4	446618-0029	Curbate inapoi	49.4	9.82-5.0	82	6 mari 6 mici
TBP4	446618-0026	Curbate inapoi	53.0	12.2-5.0	82	6 mari 6 mici
TBP4		Curbate inapoi	54.3	10.2-5.0	82	6 mari 6 mici
TBP4	446618-0024	Curbate inapoi	55.6	12.2-5.0	82	6 mari 6 mici
T04E	446618-0024	Curbate inapoi	55.45	11.7-4.5	82	6 mari 6 mici
T04E	Sant: 7.938mm	Curbate inapoi	55.45	11.7-4.5	82	6 mari 6 mici
T04R	Merge la: 465981-0007	Curbate inapoi	66.6	12.45-5.0	84	6 mari 6 mici
TA45	441793-0010	Curbate inapoi	60.5	12.85-6.1	84	6 mari 6 mici
TA45	441793-0018	Curbate inapoi	61.4	12.85-6.1	84	6 mari 6 mici
TA45	444798-0001	Curbate inapoi	62.6	14.0-6.1	84	6 mari 6 mici
TA45		Curbate inapoi	64.0	12.85-6.1	84	6 mari 6 mici
TA51	441792-0011	Curbate inapoi	66.9	13.1-6.1	91	6 mari 6 mici
T61		Curbate inapoi	61.0	11.5-5.0	91	7 mari 7 mici
T66		Curbate inapoi	65.6	11.5-4.8	91	6 mari 6 mici
T04S		Curbate inapoi	71.06	14.5-5.3	102.4	7 mari 7 mici
T72		Curbate inapoi	72.4	13.0-5.0	102.4	6 mari 6 mici
T77		Curbate inapoi	76.7	17.2-8.2	102.4	6 mari 6 mici
T74		Curbate inapoi	74.9	17.2-8.2	102.4	6 mari 6 mici
T80		Curbate inapoi	80.5	17.2-8.2	102.4	6 mari 6 mici
UTV83	443121-0003	Curbate inapoi	80.6	18.32-8.0	117.6	7 mari 7 mici
T18		Drepte inapoi	91.2	11.3-0.8	127.1	8 mari 8 mici
T18	408648-0013	Drepte inapoi	91.2	11.3-0.8	127.1	6 mari 6 mici
TL92	447187-0002	Curbate inapoi	93.7	20.35-9.65	141.3	7 mari 7 mici
GT12	: M4*0.7-LH	Curbate inapoi	22.55	4.75-2.0	38	6 mari 6 mici
GT12	434976-0005 : M4*0.7-LH	Curbate inapoi	22.55	11.5-8.75	38	6 mari 6 mici
GT12	: M4.0*0.7-LH	Curbate inapoi	31.2	6.5-2.4	44	6 mari 6 mici
GTC1244V	786554-0003	Curbate inapoi Merge la: 775517-0001	31.1	7.65-4.05	44	6 mari 6 mici
GT15	Sant: 4.00mm	Curbate inapoi	34.3	5.75-1.7	44	6 mari 6 mici
GT15	704771-0003	Curbate inapoi	29.5	5.42-2.4	44	6 long 6 shrot
GT15	436133-0003	Curbate inapoi	31.1	6.5-2.4	44	6 mari 6 mici
GT15	704771-0002	Drepte inapoi	31.1	3.36	44	6 mari 6 mici
GT15	737683-0003	Curbate inapoi Merge la: 753420	31.1	7.65-4.0	44	6 mari 6 mici
GT15	704771-0001	Curbate inapoi	32.6	5.98-3.63	44	6 mari 6 mici
GT15	436133-0002	Curbate inapoi	32.65	6.93-2.4	44	6 mari 6 mici
GT15	433287-0004 433287-0011	Curbate inapoi	32.8	6.94-2.4	44	6 mari 6 mici

GT15	433246-0003	Drepte inapoi Merge la:s 454064 / 454065 454082 / 454083	33.0	4.25	44	6 mari 6 mici
GT15	737686-0003	Curbate inapoi Merge la:s 742110-0007 758532-0012 763647-0019	32.6	7.7-4.0	46	6 mari 6 mici
GT15	704768-0005	Curbate inapoi Merge la:s 751851-0002 751851-0003	32.6	5.9-2.4	46	6 mari 6 mici
GT15	436624-0002	Curbate inapoi Merge la:s 706976 / 706977 706978	34.1	6.6-2.4	46	6 mari 6 mici
GT17	702489-0003	Curbate inapoi	32.8	5.6-2.4	49	6 mari 6 mici
GT15	434812-0001 434812-0002	Curbate inapoi	32.9	6.4-2.4	49	6 mari 6 mici
GT15	434812-0002	Curbate inapoi	33.0	6.29-2.4	49	6 mari 6 mici
GT15	702489-0002 702489-0006 702489-0009	Curbate inapoi	34.6	6.0-2.4	49	6 mari 6 mici
GT15		Curbate inapoi	34.7	6.1-2.4	49	6 mari 6 mici
GT17		Drepte inapoi	34.7	5.0	49	6 mari 6 mici
GT17		Curbate inapoi	34.8	7.75-2.4	49	6 mari 6 mici
GT17	735492-0030	Curbate inapoi Merge la: 773721-0001	34.7	8.0-3.95	49	6 mari 6 mici
GT17		Curbate inapoi	34.65	6.0-2.4	49	6 mari 6 mici
GT17		Curbate inapoi	34.65	6.0-2.4	49	6 mari 6 mici
GT17	717694-0017	Curbate inapoi Merge la: 767837-0001	34.65	7.64-3.95	49	5 mari 5 mici
GT17	436132-0003 436132-0014 436334-0003 703925-0003 703925-0011 706164-0003	Curbate inapoi	34.7	6.85-2.4	49	6 mari 6 mici
GT15	702489-0001 702489-0005	Curbate inapoi	36.4	6.2-2.4	49	6 mari 6 mici
GT16	Merge la: 757886-0004	Curbate inapoi	36.4	6.2-2.4	49	6 mari 6 mici
GT15	436624-0001	Curbate inapoi	36.4	6.45-2.4	49	6 mari 6 mici
GT15	436132-0002 436334-0002 703925-0002 703928-0002	Curbate inapoi	36.4	7.25-2.4	49	6 mari 6 mici
GT17	717694-0016	Curbate inapoi Merge la: 773721-0001	36.4	7.9-3.95	49	5 mari 5 mici
GT17		Curbate inapoi	36.4	8.25-4.0	49	6 mari 6 mici
GT17	436132-0001	Curbate inapoi	37.8	6.6-2.4	49	6 mari 6 mici
GT17	436132-0001	Curbate inapoi	37.8	7.42-2.4	49	6 mari 6 mici
GTA20	717697-0003	Curbate inapoi Merge la:s 742110-0007 758532-0012 763647-0019	34.9	7.9-4.0	52	5 mari 5 mici

GT18	702492-0011	Curbate inapoi Merge la:s 454192-0006 718089-0004 718089-0005 718089-0006 718089-0008 742807-0003 742809-0005 742810-0005 755300-0005	36.8	6.1-2.4	52	6 mari 6 mici
GT17	436131-0003 436131-0019 436131-0021	Curbate inapoi	36.8	7.1-2.4	52	6 mari 6 mici
GT22		Curbate inapoi	36.8	7.87-2.4	52	6 mari 6 mici
GT20	451584-0022	Curbate inapoi	37.6	7.24-2.4	52	6 mari 6 mici
GT20	451584-0007 436322-0006	Curbate inapoi	38.3	7.4-2.4	52	6 mari 6 mici
GT17	702492-0001 702492-0004 436131-0005	Curbate inapoi	38.6	6.5-2.4	52	6 mari 6 mici
GT17	735475-0002	Curbate inapoi Merge la:s 752990-0006 769764-0003	38.6	8.5-4.0	52	6 mari 6 mici
GT17	436131-0002 436131-0016	Curbate inapoi	38.6	7.5-2.4	52	6 mari 6 mici
GT17		Curbate inapoi	38.6	7.5-2.4	52	6 mari 6 mici
GT17		Curbate inapoi	38.8	7.55-2.4	52	6 mari 6 mici
GT22		Curbate inapoi	38.6	8.01-4.0	52	5 mari 5 mici
GT20	451584-0020	Curbate inapoi	39.0	7.56-2.4	52	6 mari 6 mici
GT22		Curbate inapoi	39.5	7.6-2.4	52	6 mari 6 mici
GT17	436131-0001	Curbate inapoi	40.0	7.73-2.4	52	6 mari 6 mici
GT20	451584-1022	Curbate inapoi Merge la: 708257-0001	37.5	7.2-2.4	52	6 mari 6 mici
GT25	436563-0003		37.6	7.6-3.75	56	6 mari 6 mici
GT20		Curbate inapoi	39.7	6.3-2.4	56	6 mari 6 mici
GT22		Curbate inapoi	39.7	7.3-2.4	56	6 mari 6 mici
GT20	701374-0003	Curbate inapoi	39.7	7.5-2.4	56	6 mari 6 mici
GT20	436563-0012 737689-0003	Deep Curbate inapoi Merge la:s 716885-0001 716885-0002 716885-0003 716885-0004 757779-0010 762060-0006	39.7	8.0-3.75	56	6 mari 6 mici
GT20		Curbate inapoi	39.7	8.0-3.75	56	6 mari 6 mici
GT22	: M5*0.8-LH	Curbate inapoi	39.7	6.7-2.4	56	6 mari 6 mici
GTB17	737689-0002	Curbate inapoi Merge la: 765314-0003	41.55	8.66-3.75	56	6 mari 6 mici
GT22		Curbate inapoi	41.6	8.61-3.75	56	6 mari 6 mici
GT25		Curbate inapoi	41.6	6.75-2.4	56	6 mari 6 mici
GT25	436563-0001 436563-0009	Deep Curbate inapoi Merge la:s 700935 / 704361 711009 / 712541 715568 / 721204 727463 / 751758	41.6	8.3-3.6	56	6 mari 6 mici

GT25	701374-0001 701374-0006	Merge la: 454191 BMW	41.6	7.64-2.4	56	6 mari 6 mici
TD25 GT25	414802-0002 : M5.0*0.8-LH	Curbate inapoi	41.6	6.8-2.4	56	6 mari 6 mici
GT25	436563-0009	Curbate inapoi Merge la: 765326-0002	41.6	8.28-3.75	56	6 mari 6 mici
GT25	: M5*0.8-LH	Curbate inapoi	41.6	6.7-2.4	56	6 mari 6 mici
GT25	737689-0001	Curbate inapoi Merge la:s 757608-0001 761399-0001 765155-0004	43.4	8.7-3.75	56	6 mari 6 mici
GT23	743345-0001	Curbate inapoi Merge la: 733676-0003	44.1	9.6-3.75	59.5	6 mari 6 mici
GT23	702549-0011	Curbate inapoi	42.0	9.21-3.75	59.5	6 mari 6 mici
GT23		Curbate inapoi	42.7	9.3-3.75	59.5	6 mari 6 mici
GT25		Curbate inapoi	44.5	8.0-2.4	59.5	6 mari 6 mici
GT23	702549-0008 702549-0014	Curbate inapoi	44.5	9.8-3.75	59.5	6 mari 6 mici
GT23		Curbate inapoi	44.5	9.65-3.75	59.5	6 mari 6 mici
GT25		Curbate inapoi	42.3	8.17-3.75	60	6 mari 6 mici
GT25		Curbate inapoi	43.0	9.21-3.75	60	6 mari 6 mici
GT25	720915-0004	Curbate inapoi	44.6	8.85-3.75	60	5 mari 5 mici
GT25		Curbate inapoi	44.6	8.56-3.75	60	5 mari 5 mici
GT25		Curbate inapoi	47	8.85-3.85	63	5 mari 5 mici
GT25	Merge la: 728989	Curbate inapoi	44.15	8.6-3.75	60	5 mari 5 mici
GT25	Merge la: 742730-0001	Curbate inapoi	44.5	8.6-3.75	60	5 mari 5 mici
GT25	787571-0002	Curbate inapoi	44.5	8.98-3.75	60	6 mari 6 mici
GT25C	447449-0010 Merge T2 model Sant: 6.0mm	Curbate inapoi	38.75	7.07-2.4	52.2	6 mari 6 mici
GT28R GT30R	452546-0005 Merge la:s 743347-0002 743347-0004 700382-0003 700382-0007 700382-0019 700382-0024	Curbate inapoi For ball bearing	53.1	8.43-2.4	71	6 mari 6 mici
GT30R	Merge la:s 700382-0011 700382-0012	Curbate inapoi For ball bearing	57	8.75-2.2	76.2	6 mari 6 mici
GT30R	Merge la: 700382-0023	Curbate inapoi For ball bearing	58	9.0-2.4	82	6 mari 6 mici
GT32		Curbate inapoi	50.85	11.0-4.8	71	6 mari 6 mici
GT32		Curbate inapoi	54.0	11.0-4.8	71	6 mari 6 mici
GT35	: M6*1.0-LH	Merge la: 452134-0002	48.9	9.46-4.8	71	6 mari 6 mici
GT35	434244-0002 : M6*1.0-LH	Curbate inapoi	51.2	10.6-4.8	71	6 mari 6 mici
GT35		Curbate inapoi	51.2	10.8-4.8	71	6 mari 6 mici
GT35	Sant: 7.8mm	Curbate inapoi	52.8	8.7-1.6	72	6 mari 6 mici
GT35	434292-0019 : M6.0*1.0-LH	Curbate inapoi	52.85	10.75-4.5	76.2	6 mari 6 mici
GT35		Curbate inapoi	52.85	10.75-4.5	76.2	6 mari 6 mici

GT35	Palete inverse	Curbate inapoi	60.0	10.2-5.0	80	9 mari
GT37	448856-0009 : M7.0*1.0-LH	Curbate inapoi	59.2	12.5-5.5	82	6 mari 6 mici
GT37		Curbate inapoi	59.2	12.2-5.5	82	7 mari 7 mici
GT37	For VAS turbo : M7.0*1.0-LH	Curbate inapoi Merge la: 743250-0004	59.2	12.3-5.5	82	7 mari 7 mici
GT37	722142-0024 : M7.0*1.0-LH	Curbate inapoi	55.6	11.5-5.5	82	7 mari 7 mici
GT37		Curbate inapoi	55.6	11.5-5.5	82	7 mari 7 mici
GT40	451644-0005 Sant: 6.35mm	Curbate inapoi	61.4	9.5-2.4	82	6 mari 6 mici
GT40	434354-0012 : M8.0*1.25-LH	Curbate inapoi	62.25	16.8-9.5	88	6 mari 6 mici
GT40		Curbate inapoi	63.5	16.85-9.5	88	6 mari 6 mici
GT40	434354-0007 : M8*1.25-LH	Curbate inapoi	64.7	17.2-9.5	88	6 mari 6 mici
GT42	: 1/4-28UNF-RH	Palete inverse Curbate inapoi	65.9	11.69-4.7	88.1	6 mari 6 mici
GT42	451193-0005 : M8*1.25-LH	Curbate inapoi	62.4	16.82-9.5	94.1	6 mari 6 mici
GT42	451162-0002	Curbate inapoi	65.1	13.6-6.04	94.1	6 mari 6 mici
GT42	434335-0049 : M8*1.25-LH	Curbate inapoi Merge la: 714311-0001	66.7	17.3-9.5	94.1	6 mari 6 mici
GTA42	: M8.0*1.0-LH	Curbate inapoi	70.4	28.5-20.9	94.1	6 mari 6 mici
GTA45	Merge la: 758160-0007 : M8.0*1.0-LH OEM is Billet	Curbate inapoi	70.9	27.55-20.15	102.4	7 mari 7 mici
GTA47	451936-0001 : 3/8-16UNF-LH	Curbate inapoi	74.7	35.58-27.0	102.4	6 mari 6 mici
GTA47	704746-0020 : 3/8-16UNF-LH	Curbate inapoi	76.55	36.2-27.0	102.4	6 mari 6 mici
GTA47	: 3/8-16UNF-LH	Curbate inapoi	78.6	36.0-27.0	108	6 mari 6 mici
GTA47	704746-0002 : 3/8-16UNF-LH	Curbate inapoi	87.8	37.0-27.0	117.7	6 mari 6 mici
GTP38R	703697-0001 Palete inverse : 1/4-28UNF-RH	Curbate inapoi Merge la: 727210-0001	59.77	12.62-5.0	80.1	5 mari 5 mici
GT		Curbate inapoi	122	17.0-10.0	170.5	8 mari 8 mici
GT	: M8.0*1.0-LH	Curbate inapoi	59.2	27.05-20.0	82	6 mari 6 mici
GT145		Curbate inapoi	100	20.45-8.5	148.5	8 mari 8 mici

Turbo Schwitzer

Model	OEM	Descriere	A Diametrul mic	B Inaltimea paletelor	C Diametrul mare	Nr.Palet
S2A	197287 Sant: 6.5mm	Curbate inapoi	43.13	13.95-8.6	61.0	7 mari 7 mici
S2B		Curbate inapoi	52	14.6-7.6	76.2	7 mari 7 mici
S2B		Curbate inapoi	56	14.6-7.6	76.2	7 mari 7 mici
S2B	314508	Curbate inapoi Merge la:s 314448 314450 315961 315981 317809 317810	50.8	14.4-8.4	76.2	6 mari 6 mici
S200	Merge la: 5620-970-0017	Curbate inapoi	44.2	8.62-4.0	63.5	7 mari 7 mici
S200	167731	Curbate inapoi	58.55	13.05-6.4	79.8	7 mari 7 mici
S2E	166835	Curbate inapoi	55.9	15.14-8.4	81.3	7 mari 7 mici
S2E	166891	Curbate inapoi	56.9	15.28-8.4	81.3	7 mari 7 mici
S2EL	194786	Curbate inapoi	47	14.22-9.4	76.2	7 mari 7 mici
S2EL	169110	Curbate inapoi	50.7	14.62-8.4	76.2	7 mari 7 mici
S3A		Curbate inapoi	63.5	17.4-9.2	91.5	7 mari 7 mici
S3A	314802	Curbate inapoi	61.0	16.45-9.2	91.5	7 mari 7 mici
S3B		Curbate inapoi	58.8	16.5-9.35	83.5	6 mari 6 mici
S3B		Curbate inapoi	63	14.15-7.0	87.5	7 mari 7 mici
S3A S3B	313412	Curbate inapoi	66.05	17.3-9.0	91.5	7 mari 7 mici
S3B	315142	Mix-flow style	66.05	---	91.4-95.3	7 mari 7 mici
S300		Mix-flow style	55.6	---	83.2-87.5	7 mari 7 mici
S300	175318	Mix-flow style	61.4	---	84.6-88.2	7 mari 7 mici
S400	168770	Mix-flow style	67.7	---	91.6-96.2	7 mari 7 mici
S400	317478	Mix-flow style	64.5	---	91.5-95.9	7 mari 7 mici
S400	168770	Curbate inapoi	66.15	16.46-8.5	91.6	7 mari 7 mici
S400		Mix-flow style	66.15	16.46-8.5	91.6	7 mari 7 mici
S410	317489	Mix-flow style	64.5	---	91.3-96.4	7 mari 7 mici
S610C		Mix-flow style	98	---	132.2-140	8 mari 8 mici
3LM	188927	Drepte inapoi	57.65	7.25	82	7 mari 7 mici
4LGZ	510916	Drepte inapoi	64.75	6.85	99	7 mari 7 mici
4LE		Drepte inapoi	62.4	8.00	94	6 mari 6 mici
4MF	5252-123-2009	Drepte inapoi	76.2	9.35	119	7 mari 7 mici
4MF	183900	Drepte inapoi	83.9	9.00	122	7 long 7short
4MD	140315	Drepte inapoi	82.55	8.60	122	7 mari 7 mici
4HF	140922	Drepte inapoi	86.4	7.50	122	7 mari 7 mici

Turbo Holset

Model	OEM	Descriere	A Diametrul mic	B Inaltimea paletelor	C Diametrul mare	Nr.Palet
HX25	3539071	Curbate inapoi	38.8	6.35-1.9	56	6 mari 6 mici
H1C/H1E	3599642 3504649	Curbate inapoi	60	12.27-4.0	83	8 mari 8 mici
H1C/H1E	3599592	Curbate inapoi	58	11.67-4.0	83	8 mari 8 mici
H1C/H1E		Curbate inapoi	56	11.30-4.0	83	8 mari 8 mici
H1C/H1E	3599637	Curbate inapoi	54	10.71-4.0	83	8 mari 8 mici
H1C/H1E	3599638 3537168	Curbate inapoi	52	10.33-4.0	83	8 mari 8 mici
H1C/H1E	3599638 3537168	Curbate inapoi	52.4	10.33-4.0	83	8 mari 8 mici
H1C/H1E	3599638 3537168	Curbate inapoi	58	10.33-4.0	83	8 mari 8 mici
H1C/H1E	3599639	Curbate inapoi	50	9.86-4.0	83	8 mari 8 mici
H1C/H1E	3599641 3537150	Curbate inapoi	48	9.35-4.0	83	8 mari 8 mici
H1C/H1E	3522824 3537150 3599641	Curbate inapoi	46	9.00-4.0	83	8 mari 8 mici
H1C/H1E	3599642	Curbate inapoi	60	11.30-4.0	83	8 mari 8 mici
H1C/H1E	3599643	Curbate inapoi	58	10.66-4.0	83	8 mari 8 mici
H1C/H1E	3599644	Curbate inapoi	56	10.31-4.0	83	8 mari 8 mici
H1C/H1E	3599645	Curbate inapoi	52	9.52-4.0	83	8 mari 8 mici
H1C/H1E	3537156	Curbate inapoi	54	10.00-4.0	83	8 mari 8 mici
HX35	3599649	Curbate inapoi	54	10.40-5.0	78	7 mari 7 mici
HX35		Curbate inapoi	50	11.00-5.0	83	8 mari 8 mici
HX35	3532312	Curbate inapoi	50	9.80-5.0	78	7 mari 7 mici
HX40	3599586	Curbate inapoi	54	11.80-5.0	83	8 mari 8 mici
HX35	3599587	Curbate inapoi	52	11.36-5.0	83	8 mari 8 mici
HX35	3599588	Curbate inapoi	50	10.80-5.0	83	8 mari 8 mici
HX35	3599589	Curbate inapoi	48	10.30-5.0	83	8 mari 8 mici
HX40	3599591	Curbate inapoi	60	12.10-5.0	83	8 mari 8 mici
HX40W	3599592	Curbate inapoi	58	11.80-5.0	83	8 mari 8 mici
HX35	3599593	Curbate inapoi	56	11.50-5.0	83	8 mari 8 mici
HX35W	3599594 3599646	Curbate inapoi	54	11.05-5.0	83	8 mari 8 mici
HX35	3599595	Curbate inapoi	52	10.60-5.0	83	8 mari 8 mici
HX40W	3599550	Curbate inapoi	60	10.95-5.0	86	6 mari 6 mici
H1C	3521863	Curbate inapoi	44	9.66-4.0	73	7 mari 7 mici
H1C	4027320	Drepte inapoi	50.3	7.3	73	7 mari 7 mici
H2C		Curbate inapoi	63	11.72-4.16	91.5	7 mari 7 mici
HX30	3599693	Curbate inapoi	40	9.54-5.0	69	6 mari 6 mici
HX40		Curbate inapoi	54	10.93-5.0	83	8 mari 8 mici
HX40	3599539	Curbate inapoi	56	11.28-5.0	83	8 mari 8 mici
HX40	4035879	Curbate inapoi	60	10.95-5.0	86	7 mari 7 mici

HX50	3593688	Curbate inapoi	63	11.85-6.26	99	7 mari 7 mici
HX50	For Master power (807575) Sant: 7.93mm	Curbate inapoi	67.0	12.5-6.2	99	7 mari 7 mici
HX55		Curbate inapoi	71.8	17.75-9.88	109	8 mari 8 mici
HX60	3534650	Curbate inapoi	80.0	18.30-9.25	113	8 mari 8 mici
HX60	3590461	Curbate inapoi	78.0	17.84-9.25	113	8 mari 8 mici
HX60	3539123	Curbate inapoi	76.0	18.04-9.25	113	8 mari 8 mici
HX60	3534648	Curbate inapoi	73.5	17.56-9.25	113	8 mari 8 mici
HY40V	3599018	Curbate inapoi	56	10.19-5.0	86	7 mari 7 mici
HY55V	3593629	Curbate inapoi	65	12.29-6.26	99	7 mari 7 mici
HY55V	3592938	Curbate inapoi	70	15.47-7.85	103	7 mari 7 mici
HT3B HT60	3527047	Curbate inapoi	73.45	19.0-9.7	109	8 mari 8 mici
HT3B HT60	Sant: 8.00mm	Curbate inapoi	73.45	17.7-9.7	109	8 mari 8 mici
HT3B HT60	3531538	Drepte inapoi	76	17.11	109	8 mari 8 mici
HC5A		Curbate inapoi	87.4	19.5-10.1	127	8 mari 8 mici

Turbo MHI

Model	OEM	Descriere	A Diametrul mic	B Inaltimea paletelor	C Diametrul mare	Nr.Palet
TD02	Palete inverse	Drepte inapoi	26.2	3.25	39	6 mari 6 mici
TD02	49173-00015 49173-06500	Drepte inapoi Tip height: 4.4mm	29	4.4	40	6 mari 6 mici
TD02	Merge la:s 49173-07502 49173-07507	Drepte inapoi Tip height: 4.1mm	29	4.1	40	6 mari 6 mici
TD03	Merge la:s 49131-06003 49131-04300	Curbate inapoi	32	5.90-1.7	44	6 mari 6 mici
TD03		Curbate inapoi	33	6.00-1.7	44	6 mari 6 mici
TD03	Merge la:s 49173-02401 49173-02410 49173-02412	Curbate inapoi	34.1	6.20-1.7	44	6 mari 6 mici
TD03		Curbate inapoi	35	7.6-1.7	44	6 mari 6 mici
TF035	TF035HL	Curbate inapoi	36.3	6.80-1.85	49	6 mari 6 mici
TF035	Sant: 4.00mm	Curbate inapoi	36.3	6.80-1.85	49	6 mari 6 mici
TD04	49171-41410 TD04-09B	Drepte inapoi	34.8	4.7	49	12 long
TD04	49177-44200	Drepte inapoi	35.5	5.6	49	6 mari 6 mici
TD04	49177-44400 TD04-12T	Drepte inapoi	37.75	5.25	49	6 mari 6 mici
TD04	Merge la:s 49135-06020 49177-02551	Curbate inapoi TD04-10T	35.5	6.30-1.85	49	6 mari 6 mici
TD04	49135-00016	Curbate inapoi	37.75	7.1-1.85	49	6 mari 6 mici
TD04	49177-43300	Curbate inapoi	38	6.85-1.85	49	6 mari 6 mici
TD04	Merge la: 49377-07421	Curbate inapoi	36.5	6.0-1.85	51	6 mari 6 mici
TF035	Merge la: 49135-07100 TF035HL	Curbate inapoi	36.65	7.64-1.85	51	6 mari 6 mici
TF035	Merge la: 49135-05671 TF035HL	Curbate inapoi	38.4	6.0-1.85	51	6 mari 6 mici
TD04	For MD44	Curbate inapoi	38.4	6.5-1.85	51	6 mari 6 mici
TD04	49177-43400 TD04-14T	Curbate inapoi Merge la:s 49177-02640 49377-00100 49377-00110 49377-00120 49377-02100 49377-06000 49377-06010 49377-06150 49377-06160 49377-06213 49377-07000 49377-07010 49377-07050 49377-07070 49377-07310	39.55	7.25-1.85	51	6 mari 6 mici
TD04	49377-00017 TD04-13T	Curbate inapoi Merge la:s 49377-04200 49377-04300	40.85	6.78-1.85	56	6 mari 6 mici
TD04	49189-43500 TD04-15T	Curbate inapoi	42.0	7.20-1.85	56	6 mari 6 mici
TD04	49189-40300 TD04HL-15G-8.5	Drepte inapoi	43.4	5.35	56	6 mari 6 mici

TD04	49189-00016 49189-43600 TD04-16T	Curbate inapoi	43.4	7.55-1.85	56	6 mari 6 mici
TD04	49189-43800 TD04-18T	Curbate inapoi Merge la:s 49189-01370 49189-01375	45	7.45-1.85	56	6 mari 6 mici
TD04	49189-43900 TD04-19T	Curbate inapoi Merge la:s 49189-05310 49189-05400	46	7.65-1.85	58	6 mari 6 mici
TD04		Curbate inapoi	46.7	7.65-1.85	58	6 mari 6 mici
TD04		Curbate inapoi	46.7	7.65-1.85	60	6 mari 6 mici
TD04		Curbate inapoi	46.6	7.65-1.85	58	6 mari 6 mici
TD05	49179-42100 TD05-16G6 (Evo3)	Curbate inapoi	48.3	8.0-2.85	68	6 mari 6 mici
TD05	49179-43300 TD05-18G	Curbate inapoi	50.5	8.53-2.8	68	6 mari 6 mici
TD05	49179-43400 TD05-20G	Curbate inapoi	52.6	9.0-2.8	68	6 mari 6 mici
TD05		Curbate inapoi	54	9.0-2.8	68	6 mari 6 mici
TD05	49179-43200 TD05-16G "Big"	Curbate inapoi	48	9.0-2.8	68	6 mari 6 mici
TD05	Sant: 5.7mm	Curbate inapoi	52.6	9.0-2.8	68	6 mari 6 mici
TD06		Drepte inapoi	41	4.4	65	7 mari 7 mici
TD06		Drepte inapoi	44.45	5.35	65	7 mari 7 mici
TD06		Curbate inapoi	56.3	9.3-2.7	75	6 mari 6 mici
TD06	Sant: 5.7mm	Curbate inapoi	56.3	9.3-2.7	75	6 mari 6 mici
TD06	Palete inverse	Curbate inapoi	56.3	9.3-2.7	75	6 mari 6 mici
TD06	49168-41300	Curbate inapoi	53.9	9.1-3.0	76.2	6 mari 6 mici
TD06	Palete inverse	Curbate inapoi	55.1	8.15-2.9	76.2	7 mari 7 mici
TD07			53	8.44-2.7	75	7 mari 7 mici
TD07		Curbate inapoi	55.4	9.7-2.7	78	12 long
TD07		Curbate inapoi	60.4	9.5-2.7	78	6 mari 6 mici
TD07	Sant: 5.7mm	Curbate inapoi	60.4	9.7-2.7	78	6 mari 6 mici
TD06		Curbate inapoi	61.4	9.5-2.4	82	6 mari 6 mici
TD06	Sant: 5.7mm	Curbate inapoi	61.4	9.72-2.4	82	6 mari 6 mici
TD06	Sant: 6.35mm	Curbate inapoi	61.4	9.5-2.4	82	6 mari 6 mici
TD08		Curbate inapoi	61.45	8.7-2.9	92	7 mari 7 mici
TD10		Curbate inapoi	84.6	14.26-2.9	108	12 long
TD13		Curbate inapoi	95.25	13.25-4.05	135.9	8 mari 8 mici

Turbo IHI

Model	OEM	Descriere	A Diametrul mic	B Inaltimea paletelor	C Diametrul mare	Nr.Palet
RHF3		Curbate inapoi	31	4.65-1.13	40	6 mari 6 mici
RHF3	For VL20	Curbate inapoi	31	5.42-1.13	40	5 mari 5 mici
RHF4	For VJ30	Curbate inapoi	34	5.3-1.3	48	6 mari 6 mici
RHF4	For VJ32	Curbate inapoi	35.4	5.3-1.3	52.5	7 mari 7 mici
RHF4	For VV14	Curbate inapoi	37.45	6.15-1.3	52.5	10 long
RHF5		Curbate inapoi	35.4	6.15-1.3	47	6 mari 6 mici
RHF5	Merge la: 8971480750	Curbate inapoi	37.2	5.6-0.6	48	6 mari 6 mici
RHF5	For ball bearing	Curbate inapoi	38.55	5.2-0.6	52.5	5 mari 5 mici
RHF5		Curbate inapoi	38.25	6.15-1.3	52.5	10 long
RHB5		Drepte inapoi	38.5	4.82	52.5	5 mari 5 mici
RHB5		Curbate inapoi	38.3	5.2-0.6	52.5	5 mari 5 mici
RHF		Curbate inapoi	48	7.7-2.03	68	5 mari 5 mici
RHF		Curbate inapoi	48	7.7-2.03	68	5 mari 5 mici
RHC6		Curbate inapoi	46.5	9.7-4.15	69	6 mari 6 mici
RHC6		Curbate inapoi	51.3	10.3-4.15	70	6 mari 6 mici
RHE6	Merge la: VA720033	Curbate inapoi	56.15	12.0-5.0	75.5	6 mari 6 mici
RHE6		Curbate inapoi	50.7	11.3-5.3	75.5	6 mari 6 mici
RHE6		Curbate inapoi	53	12.2-5.3	75.5	6 mari 6 mici
RHE6		Curbate inapoi	53.39	12.2-5.3	75.2	6 mari 6 mici
RHX6	For ball bearing	Curbate inapoi	53.37	9.7-4.3	78	5 mari 5 mici
RHC6		Curbate inapoi	56.25	12.0-5.0	82	5 mari 5 mici
RHC7		Curbate inapoi	53.65	8.45-2.75	76	5 mari 5 mici
RHC7		Curbate inapoi	56.15	12.0-5.0	82	6 mari 6 mici
RHC7		Curbate inapoi	59.65	12.0-5.0	82	6 mari 6 mici
RHC7		Curbate inapoi	60.7	11.5-5.0	82	6 mari 6 mici
RHE7		Curbate inapoi	57.3	12.5-5.9	82	6 mari 6 mici
RHE7		Curbate inapoi	59.12	12.5-5.9	82	6 mari 6 mici
RHE7		Curbate inapoi	59.53	12.5-5.9	82	6 mari 6 mici
RH110		Curbate inapoi	76.1	11.93-3.0	112	12 mari

Turbo Toyota

Model	OEM	Descriere	A Diametrul mic	B Inaltimea paletelor	C Diametrul mare	Nr.Palet
CT-Yaris	Merge la: 17201-33010	Curbate inapoi	27.3	5.35-1.76	40	5 mari 5 mici
CT	Merge la: 17201-30080	Curbate inapoi	36	7.1-2.6	51	6 mari 6 mici
CT9		Curbate inapoi	34	5.3-0.7	48	4 mari 4 mici
CT	OEM is Billet CW	Curbate inapoi	40.6	8.0-2.6	55.7	6 mari 6 mici
CT12	Merge la: 17201-0L040	Curbate inapoi	39.1	7.0-2.5	58	6 mari 6 mici
CT12B	Sant: 5.7mm	Curbate inapoi	37.05	5.70-1.0	54	5 mari 5 mici
CT12B	Merge la:s 17201-67010 17201-67040	Curbate inapoi	43	6.55-1.0	58	5 mari 5 mici
CT12B	Sant: 6.5mm	Curbate inapoi	41.95	5.8-0.5	58	5 mari 5 mici
CT20	Merge la: 17201-54030	Curbate inapoi	36.12	4.24-1.45	57	5 mari 5 mici
CT20		Curbate inapoi	39.65	4.7-0.7	57	6 mari 6 mici
CT26	Merge la: 17201-42020 Sant: 5.7mm	Curbate inapoi	46	7.10-1.8	65	5 mari 5 mici
CT26	Sant: 5.7mm	Drepte inapoi (With depth)	46	5.35	65	5 mari 5 mici
CT26	Sant: 6.5mm	Drepte inapoi (With depth)	46	5.32	65	5 mari 5 mici
CT26	Sant: 6.5mm	Curbate inapoi	46.05	7.15-1.85	65	5 mari 5 mici
CT26	Sant: 6.5mm	Curbate inapoi	46.05	6.1-0.8	65	5 mari 5 mici
CT26	Merge la:s 17201-17010 17201-17030 17201-42060 17201-74010 17201-74020 17201-74030	Drepte inapoi (With depth)	42	4.7	65	5 mari 5 mici

Turbo Hitachi

Model	OEM	Descriere	A Diametrul mic	B Inaltimea paletei	C Diametrul mare	Nr.Palet
HT10		Drepte inapoi	41	6.1	54	5 mari 5 mici

Turbo CZ

Model	OEM	Descriere	A Diametrul mic	B Inaltimea paletei	C Diametrul mare	Nr.Palet
C12	3601-209C	Curbate inapoi	35	7.17-2.0	50	6 mari 6 mici
C14	399-3601-430	Curbate inapoi	42	7.36-2.05	60	6 mari 6 mici
K27	2902-020S	Drepte inapoi	48.2	6.98	76	6 mari 6 mici
K36	399-0902-033	Drepte inapoi	68.25	8.3	102	7 mari 7 mici

Turbo TKR

Model	OEM	Descriere	A Diametrul mic	B Inaltimea paletei	C Diametrul mare	Nr.Palet
TKR-7C6		Curbate inapoi	49.4	7.2-0.8	76	8 mari 8 mici

Altele

Model	OEM	Descriere	A Diametrul mic	B Inaltimea paletei	C Diametrul mare	Nr.Palet
J35			25.3	4.2	37	6 mari 6 mici
K-027		Drepte inapoi	52	6.2	76.2	12 long
J70		Drepte inapoi	50.65	6.7	76.3	7 mari 7 mici
J90			61	7.65	91.5	7 mari 7 mici
J95			59.4	7.5	94	6 mari 6 mici
HNYL-5	4827-17	Curbate inapoi	76	16.25-7.95	108	6 mari 6 mici
Komatsu-6			39	5	61	7 mari 7 mici
JMB T180		Curbate inapoi	56	10.8-3.23	76	8 mari 8 mici
YL-16		Curbate inapoi	39.4	13.55-8.4	61.0	7 mari 7 mici
HNYL-13		Curbate inapoi	52.85	8.35-1.6	70	6 mari 6 mici
S50-04	QC2759	Drepte inapoi	35.0	4.5	50.0	6 mari 6 mici
SV45		Curbate inapoi	46.5	7.5-2.4	60.1	6 mari 6 mici
YJP60		Curbate inapoi	42.8	7.57-2.2	59.5	6 mari 6 mici